

NRX-12

4WD
M-CHASSIS
210mm

M-CHASSIS ELECTRIC RACING CAR

INSTRUCTION MANUAL

- > Wheelbase: 210mm.
- > Track width: 165mm.
- > Innovative rear body post mounting position.
- > Full time 4WD high efficient shaft drive transmission.
- > CNC-machined lightweight fibre chassis, upper deck, front bumper plate, battery bar holder.
- > Fully rebuildable lightweight CVD drive shaft.
- > Front/rear ball differentials.
- > Compatible with all M chassis bodies by changing front body mounts.
- > Compatible with 4-6 cells battery pack and LIPO battery.
- > CNC-machined high precision aluminium motor mount and threaded shocks.

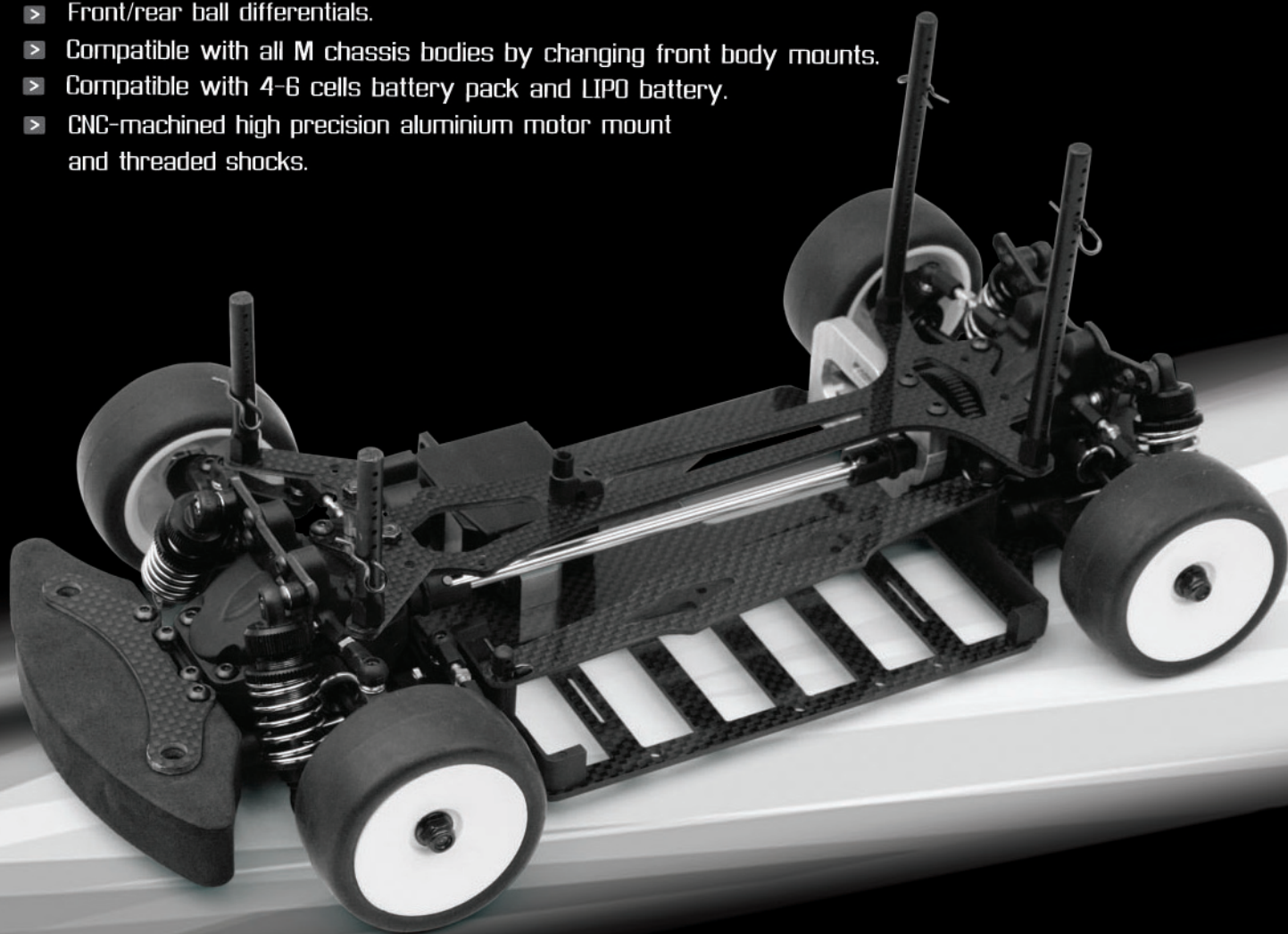

Please read these instructions thoroughly before assembling

NRX-12

M-CHASSIS ELECTRIC RACING CAR

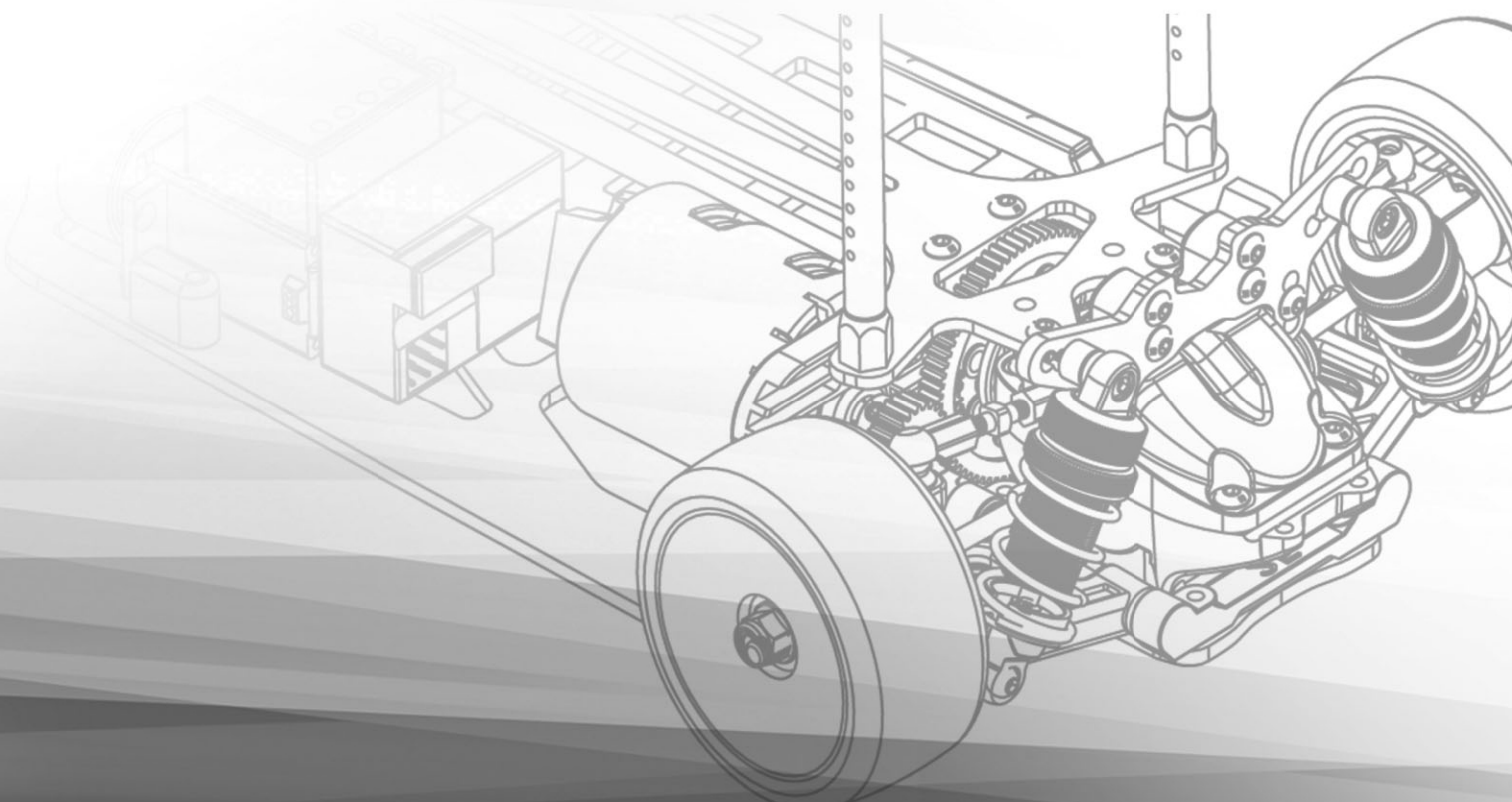

Before commencing assembly, please read these instructions thoroughly

CAUTION Do not drive the following places.



Do not drive on public streets or highways. This could cause serious accidents, personal injuries, and/or property damage.



Do not drive in water or sand.

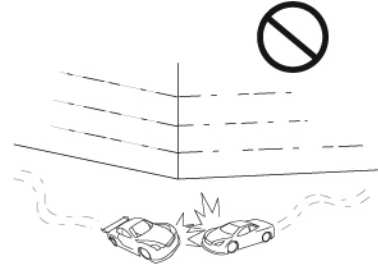

Make sure everyone is using different frequencies when driving together in the same area.

Important Basics

Build this Kit in an area away from small children. Tool, parts and liquids can be dangerous! Also, provide adult supervision if a child is building this kit.

Follow the operating instructions for the radio equipment at all times.

Always turn on the transmitter before you turn on the car.

Keep the wheels of the car off the ground when checking the operation of the radio equipment.

Always turn off the radio system and unplug the battery pack when not using the car.

Follow the operating instructions for the Ni-Cd batteries pack when not using the car.

Insulate any exposed electrical wiring with heat shrink tubing to prevent dangerous short-circuits.

Technical Data

Chassis Full length/282mm

Chassis Width/F/163mm R/163mm · 169mm

Chassis Wheel Base 208mm · 210mm

F.caster Angle/4DEGREE

Gear Ratio/4.126:1(31T PINION)

NRX-12 M-CHASSIS ELECTRIC RACING CAR

Equipment Needed: (Not Included)

Radio Gear/Fernsteueranlage/Equipement Radio

Radio control system

You will need a-Channel radio system with one servo, receiver and electronic speed control with an ON/OFF switch.



8AA Alkaline Dry Batteries.

8x



7.2V Battery



540 Motor



Transmitter



7.2V Compatible Charger

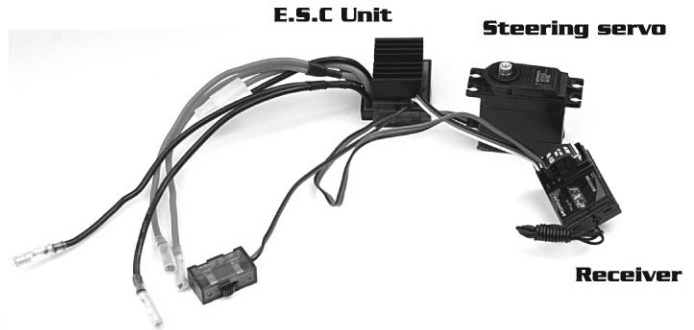

E.S.C Unit

Steering servo

Receiver

Tools Recommended: (Not Included)

Modelling Knife

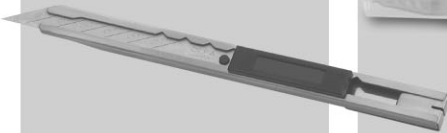

Instant Adhesive



Needle Nose Pliers

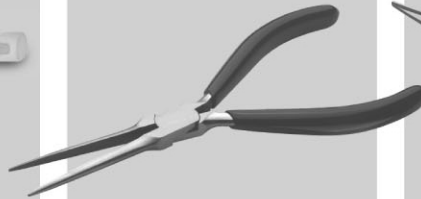

Scissors



Phillips Screwdriver
1,5 / 2 / 2,5 mm



Precision Caliper

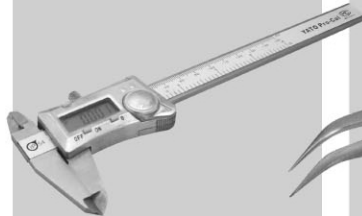

Tweezers

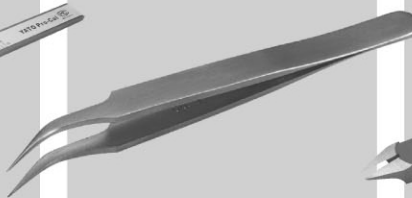

Side Cutter

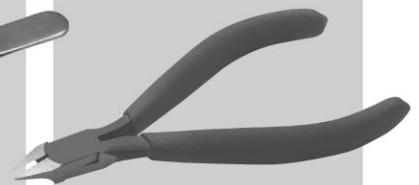

Included Items:











HEX WRENCH 1.5mm



HEX WRENCH 2.0mm

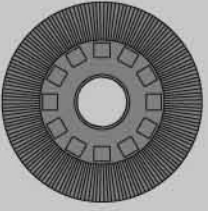

SHOCK OIL

	X4
NB1001A052 13X19X0.6mm	
	X2
NB1001B002	
	X2
NB1001B004 2.6X6X3.5mm	
	X4
BA1001B009 5X8X2.5mm	
	X4
NB1001B003 10X15X4mm	
	X2
NB1001B005 M2.5X23mm	
	X2
UG0015B004 M2.5	
	X6
NA1007A004 3/32 "	
	X2
NB1001C029	

01

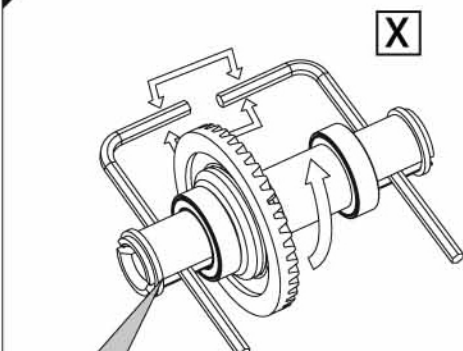

NOTE:
Push the diff gear from both sides of diff outrives to make sure it's tight enough.

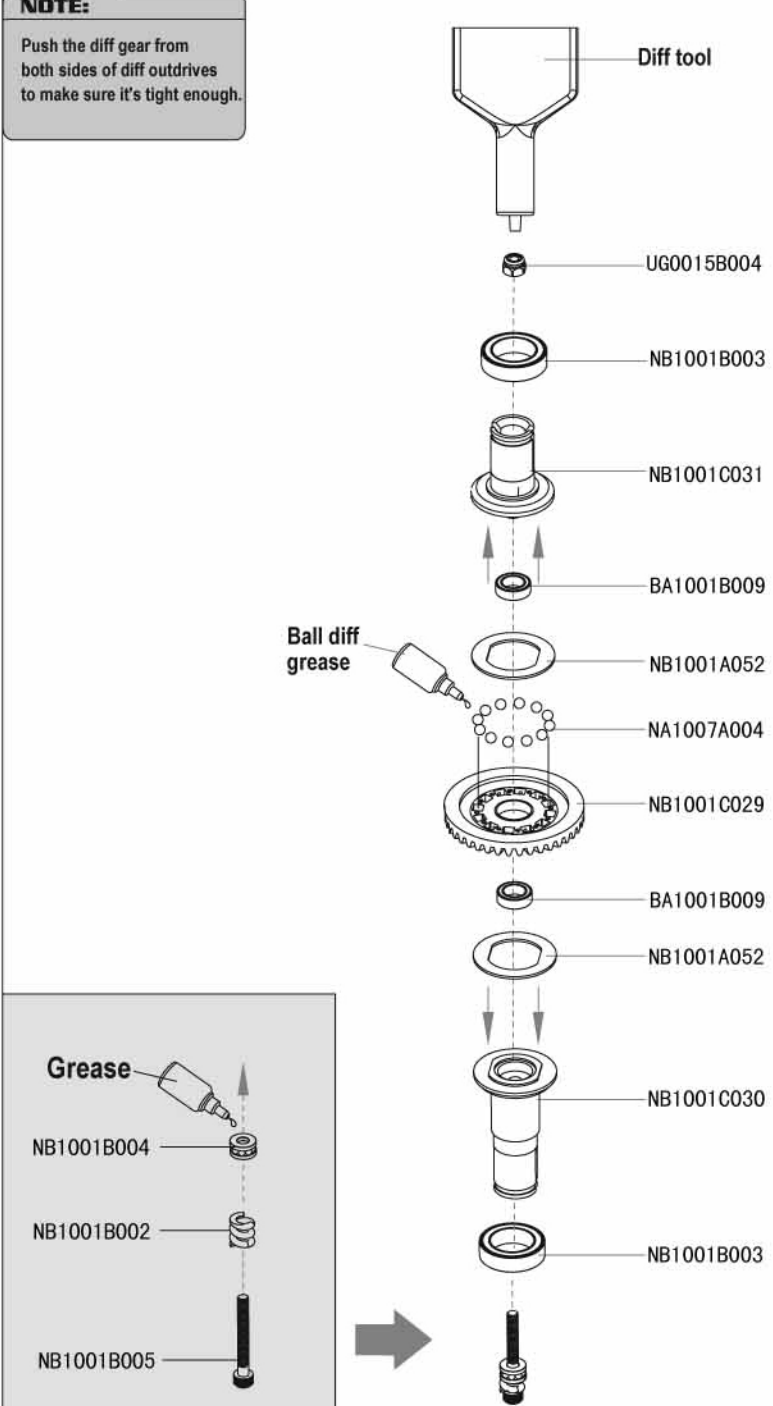
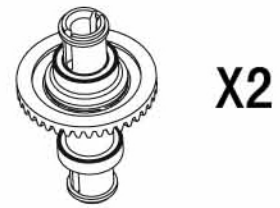

02

-  **X4**
- BB1001B014**
M3X8mm
-  **X2**
- BA1001B016**
M3
-  **X3**
- NA1001B015**
M3X8mm
-  **X3**
- NB1001A070**
3X8mm
-  **X2**
- NB1001A066**
M3

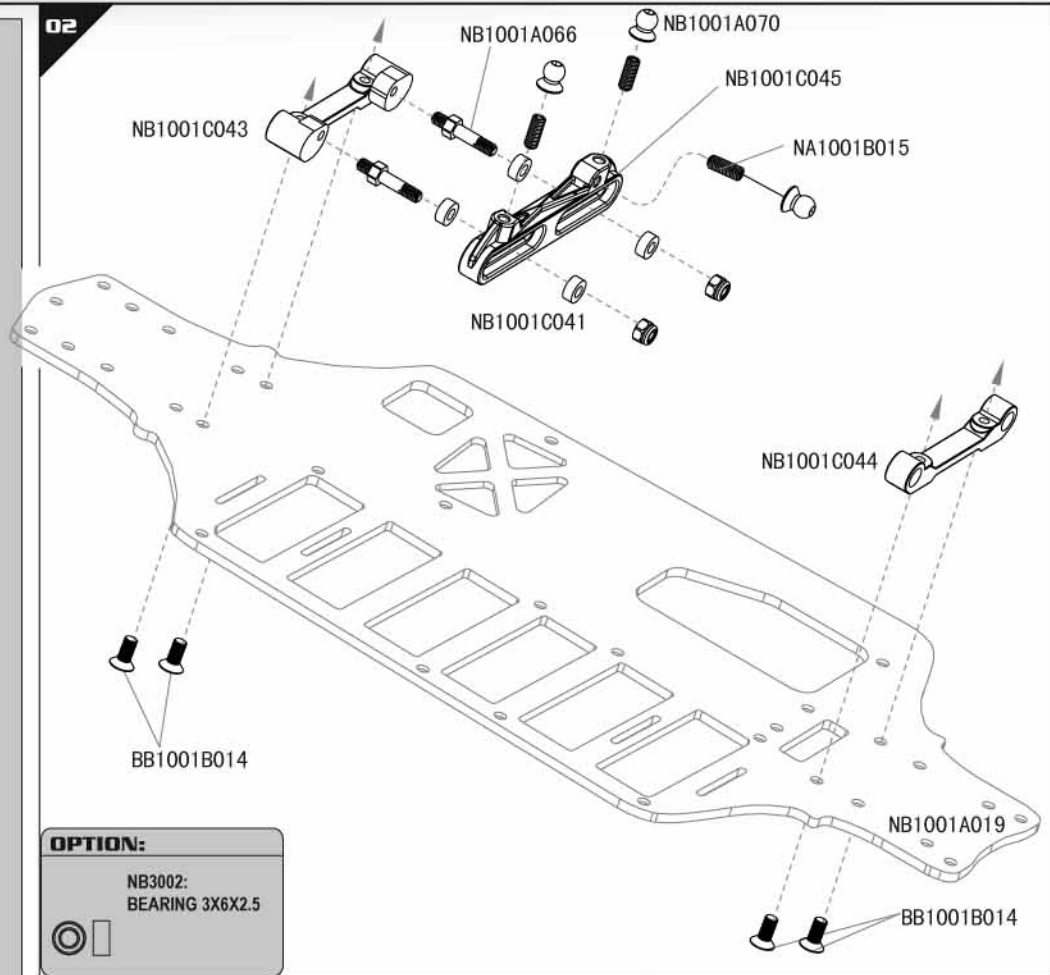

OPTION:
NB3002:
BEARING 3X6X2.5



-  **X2**
- BB1001B014**
M3X8mm
-  **X2**
- NC1001B004**
M3X10mm
-  **X4**
- NB1001A018**
-  **X2**
- NB1001A016**

03

Set up tip:

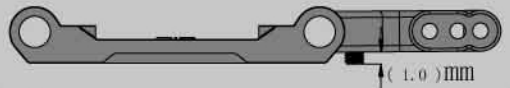

(1.0)mm

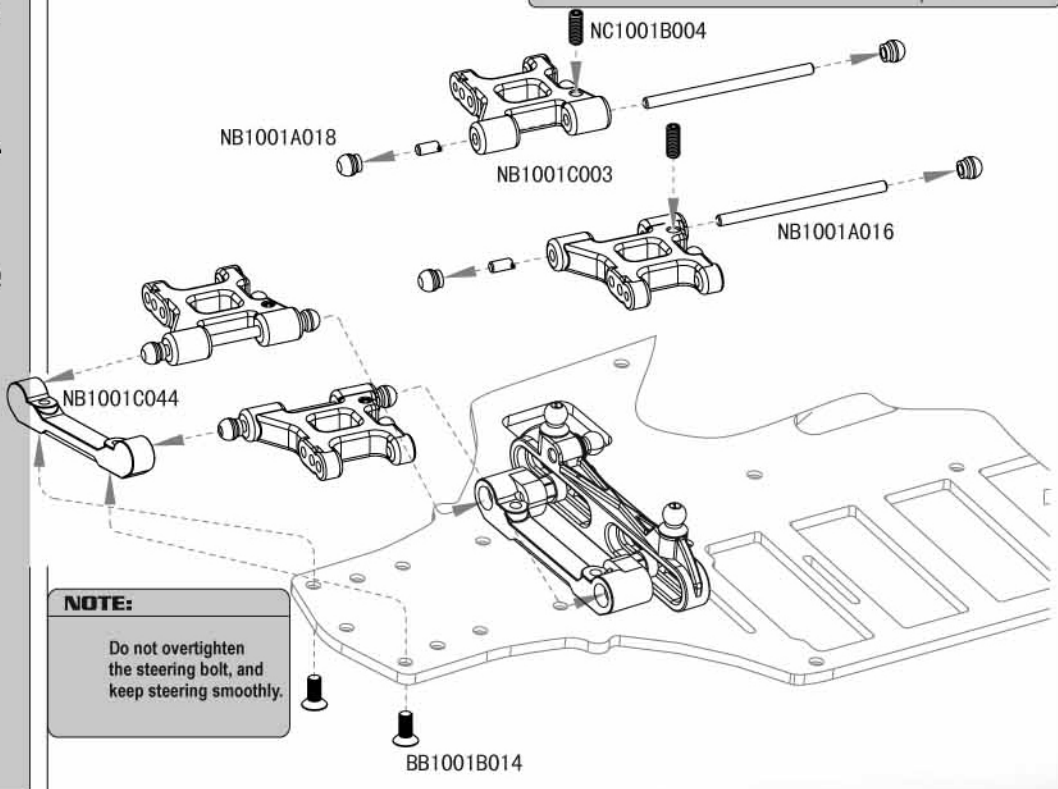

NOTE:
Do not overtighten
the steering bolt, and
keep steering smoothly.

04

-  **X2**
BB1001B014
M3X8mm
-  **X2**
NC1001B004
M3X10mm
-  **X4**
NB1001A018

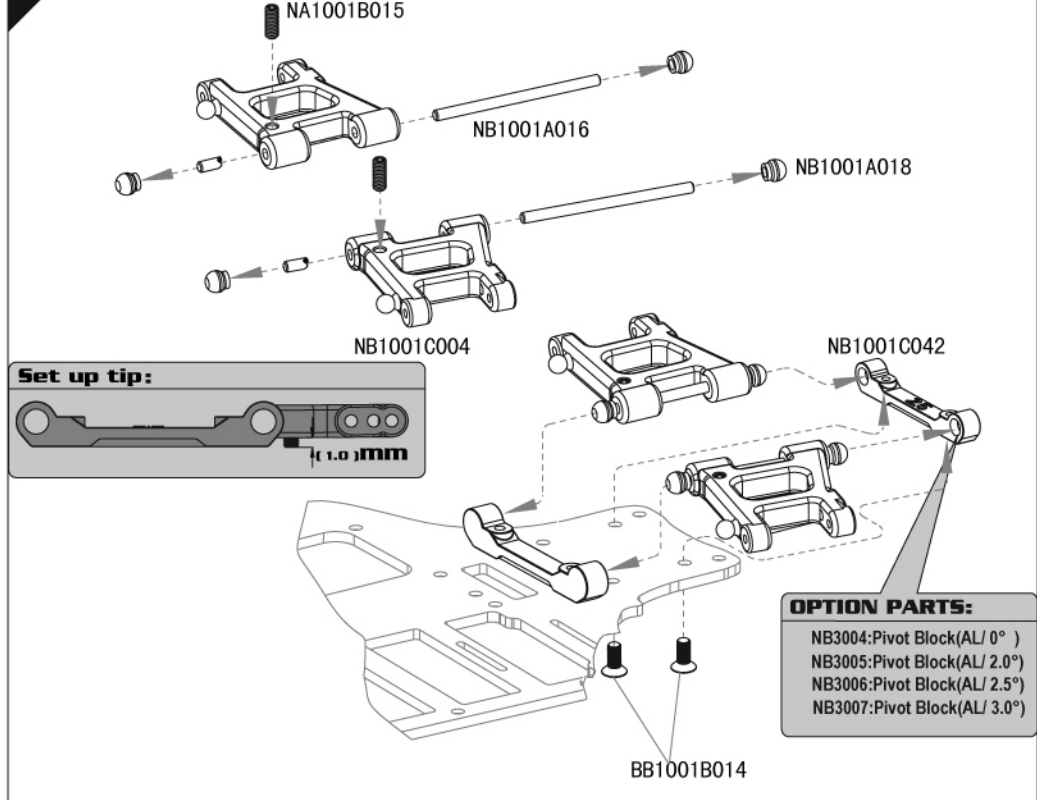

-  **X2**
BB1001B014
M3X8mm
-  **X2**
NB1001A043
-  **X1**
NA1001B015
M3X8mm
-  **X1**
NB1001A070
3X8mm
-  **X2**
BB1001B063
M3X6mm
-  **X1**
BB1001B039
M3X12mm
-  **X1**
BA1001B011
3.2X9X0.8mm

05

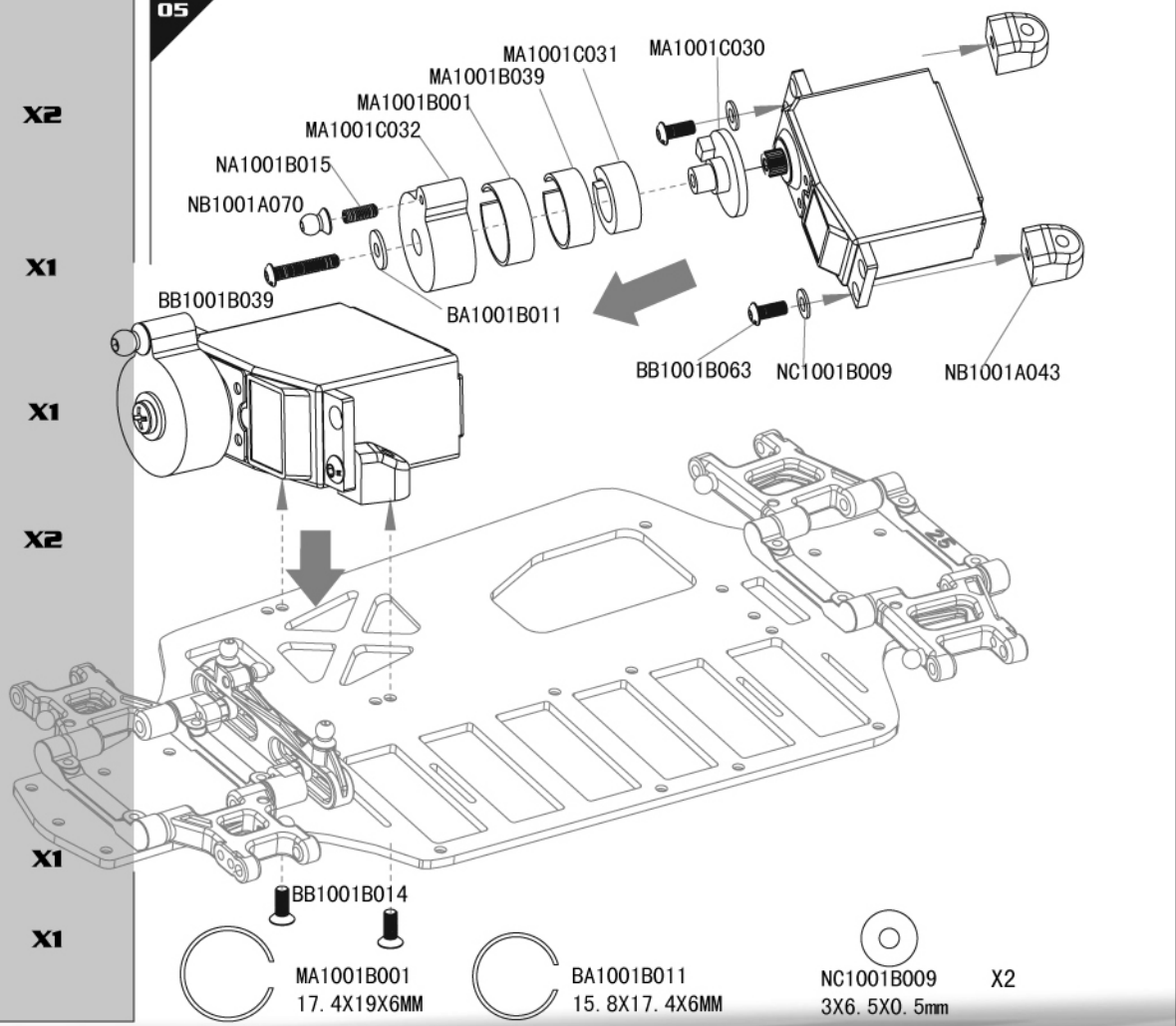

-  **X1**
MA1001B001
17. 4X19X6MM
-  **X2**
BA1001B011
15. 8X17. 4X6MM
-  **X2**
NC1001B009
3X6. 5X0. 5mm

06



X10

BB1001B014
M3X8mm

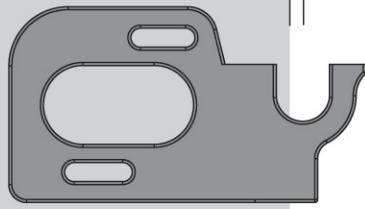

NB1001A001

X1

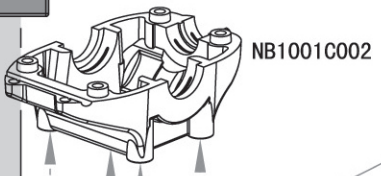

NB1001A001

NB1001C002

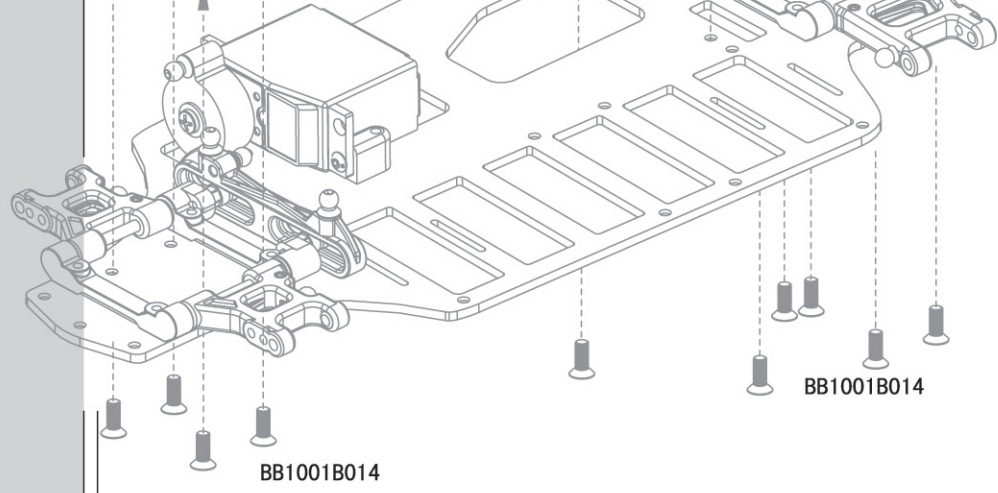
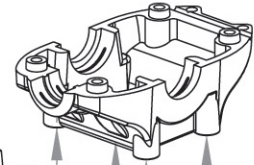

X1

BB1001B014
M3X8mm



X2

BA1001B007
5X10X4mm



X1

BB1001D009
5.8X9.6mm

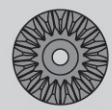

X1

NB1001C032 17T



X1

NB1001A058
2X7.6mm

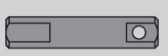







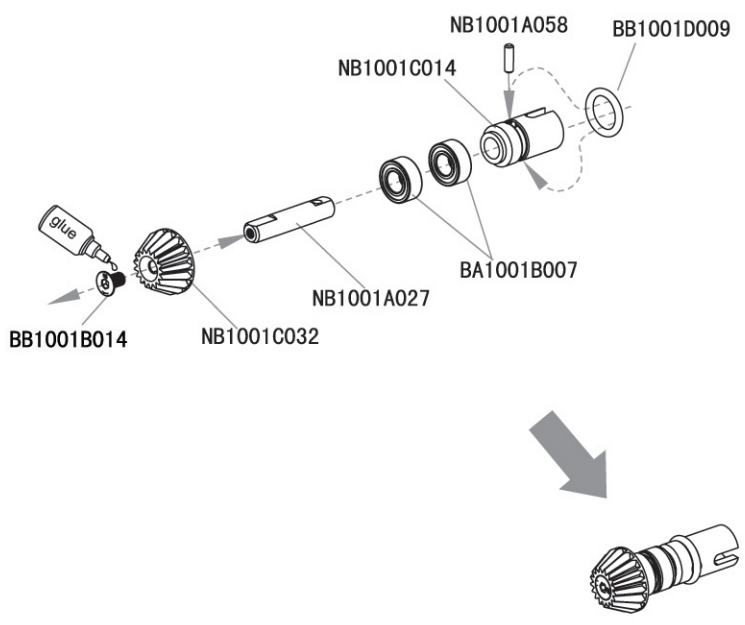



X1

NB1001A027

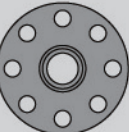
07

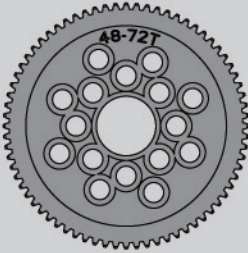
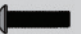

-  **X1**
BB1001B014
M3X8mm
-  **X4**
NB1001B009
M3X6mm
-  **X2**
NB1001A058
2X7.6mm
-  **X1**
NB1001A041
5.1X6.8X2mm
-  **X1**
BB1001D009
7X10X1.5
-  **X3**
BA1001B007
5X10X4mm
-  **X1**
NB1001A030
-  **X1**
NB1001C032 17T
-  **X1**
NB1001C033 72T
-  **X2**
BB1001B059
M3X10mm
-  **X2**
NC1001B011
M3X8mm

08

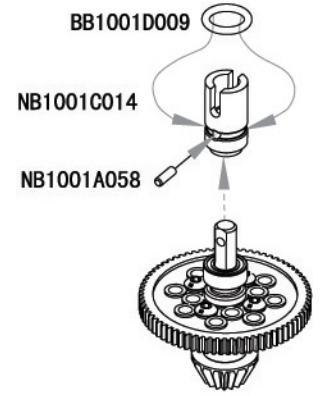
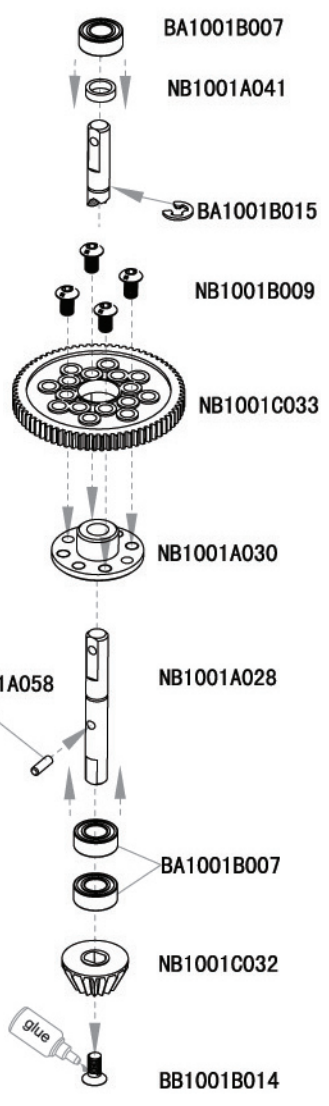

09

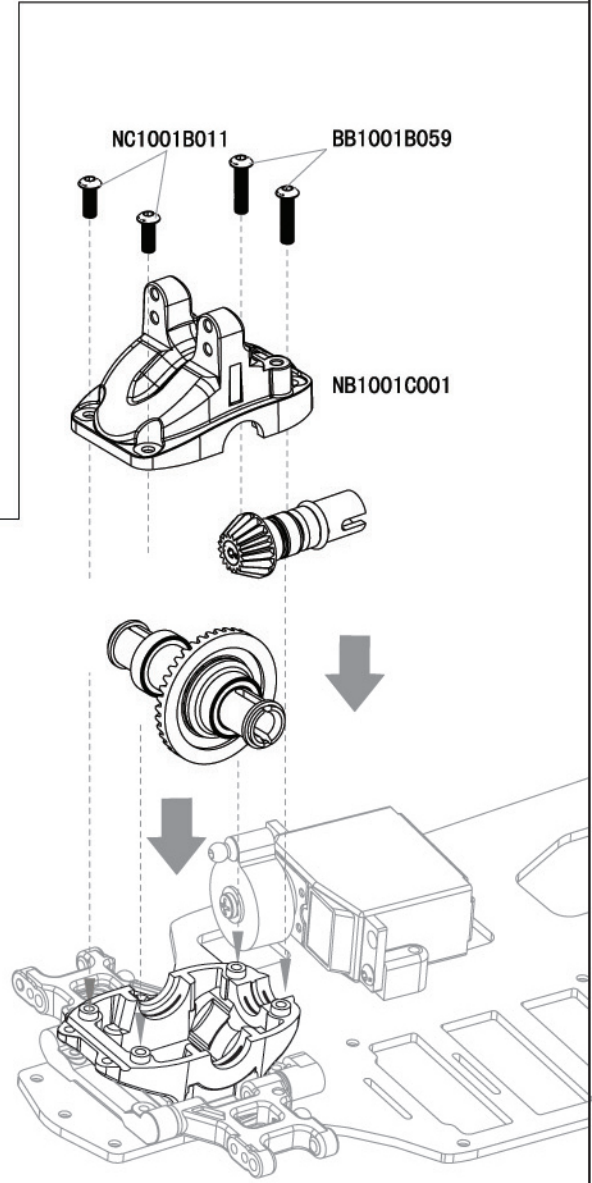

10

-  **X2**
NC1001B011
M3X8mm
-  **NB1001A01**
-  **X2**
BB1001B059
M3X10mm
-  **X1**
NC1001A001
2X10.0mm
-  **X1**
NB1001A006
12mm
-  **X2**
BA1001B007
5X10X4mm
-  **X2**
BB1001B059
M3X10mm
-  **X2**
NB1001A015
3X7X4.2mm
-  **X2**
NA1001B015
M3X8mm
-  **X2**
NB1001A070
3X8mm
-  **X1**
NB1001B017
M2X5mm
-  **X1**
NB100103
CVD

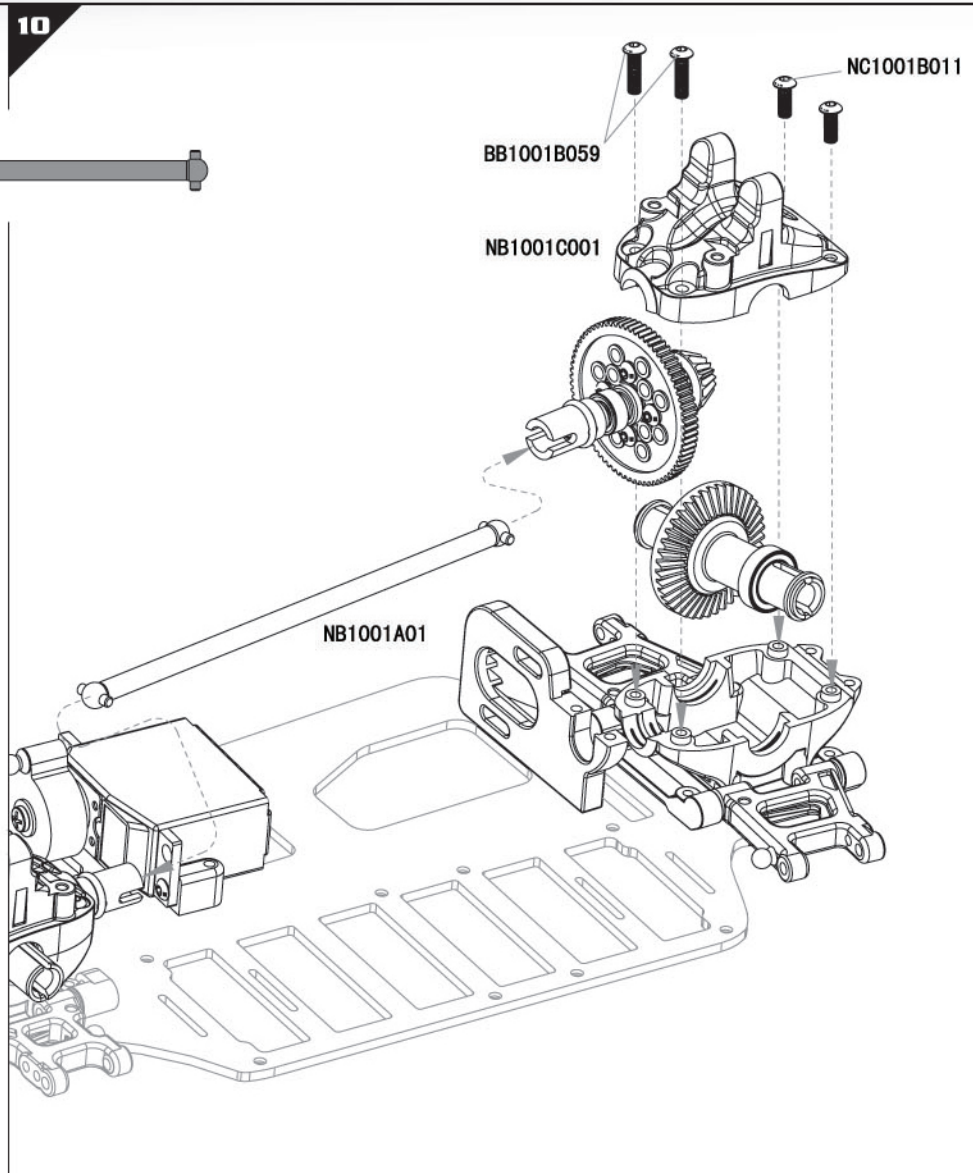

11

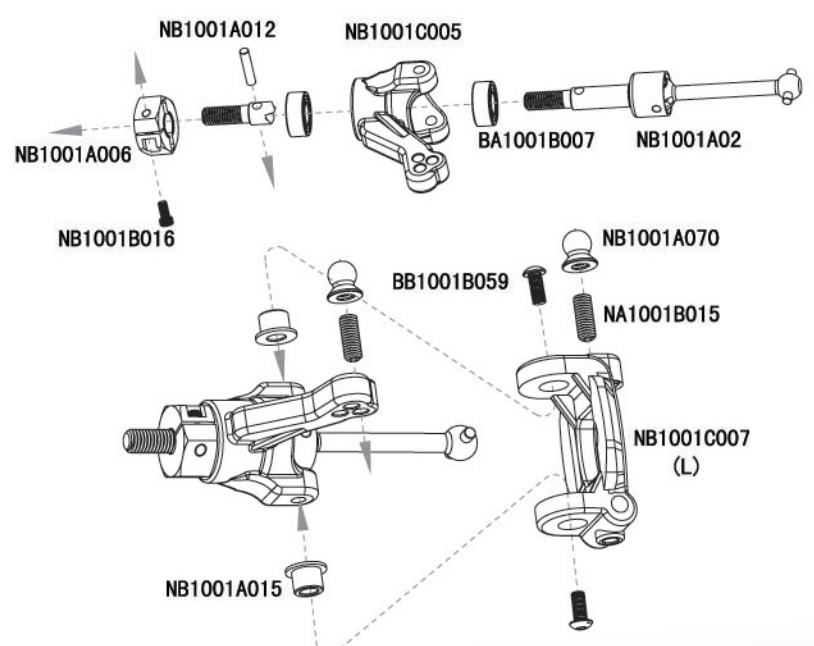

12

-  **NC1001A001** X1
2X10mm
-  **NB1001A006** X1
12mm
-  **BA1001B007** X2
5X10X4mm
-  **BB1001B059** X2
M3X10mm
-  **NB1001A015** X2
3X7X4.2mm
-  **NA1001B015** X2
M3X8mm
-  **NB1001A070** X2
3X8mm
-  **NB1001B017** X1
M2X5mm
-  **NB100103** X1
CVD

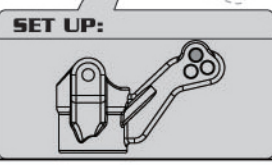
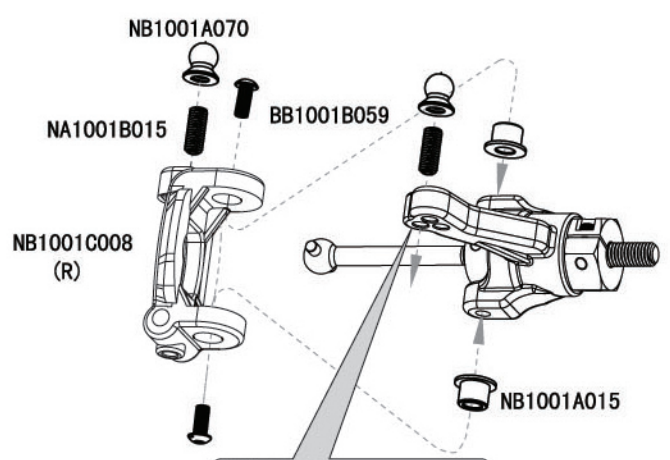
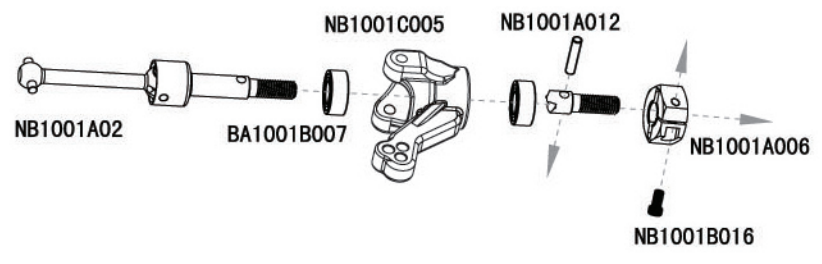

13

-  **NC1001B019** X2
M3X4mm
-  **NB1001A053** X2
9.5X11.5X1mm
-  **NB1001A045** X2
2.5X23mm

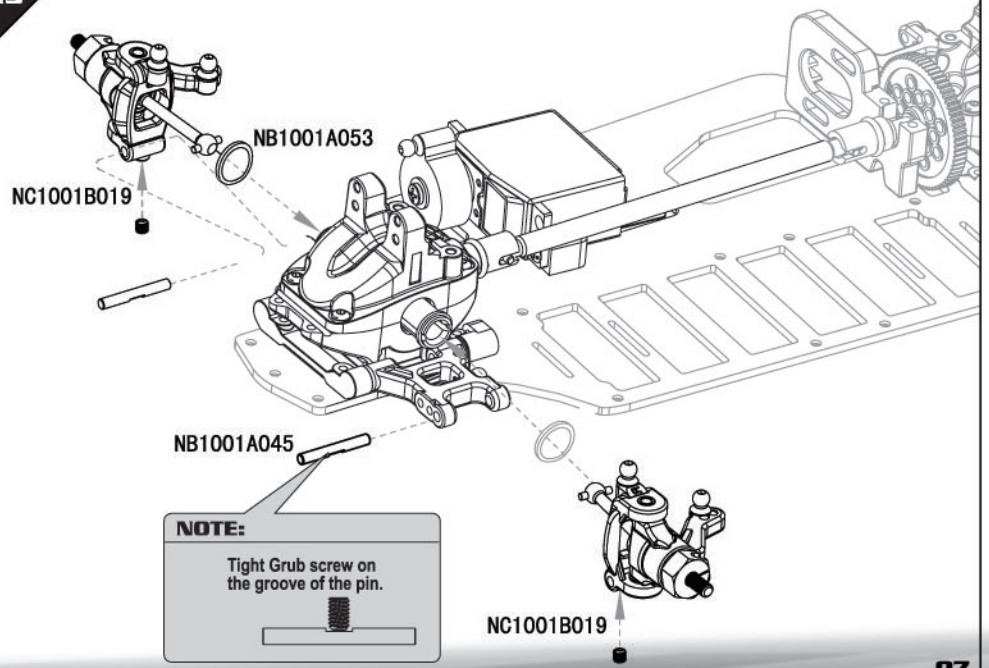

NOTE:
Tight Grub screw on the groove of the pin.

14



BA1001B007
5X10X4mm **X4**



NB1001A006
12mm **X2**



NC1001A001
2X10mm **X2**



NA1001B015
M3X8mm **X2**



NB1001A070
3X8mm **X2**



NB1001B017
M2X5mm **X2**



NB1001A017
2.5X26mm **X2**



NB1001A049
2.5X5X1.5mm **X4**



NC1001B019
M3X4mm **X2**



NB1001A053
9.5X11.5X1mm **X2**

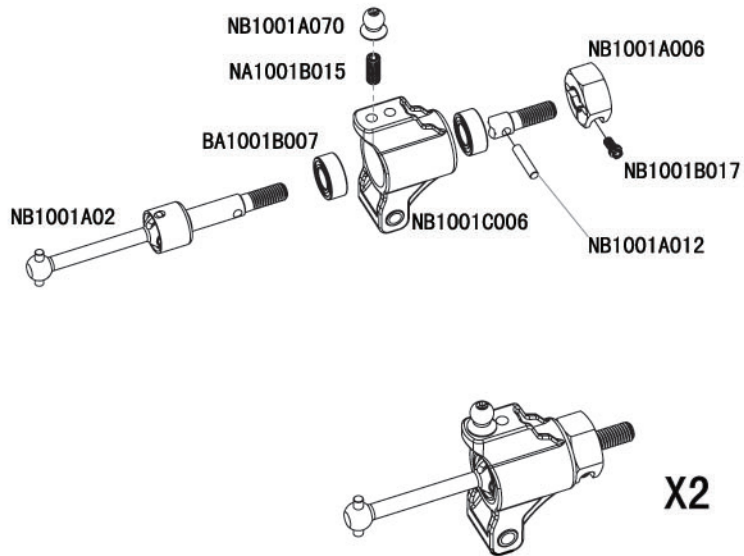

15

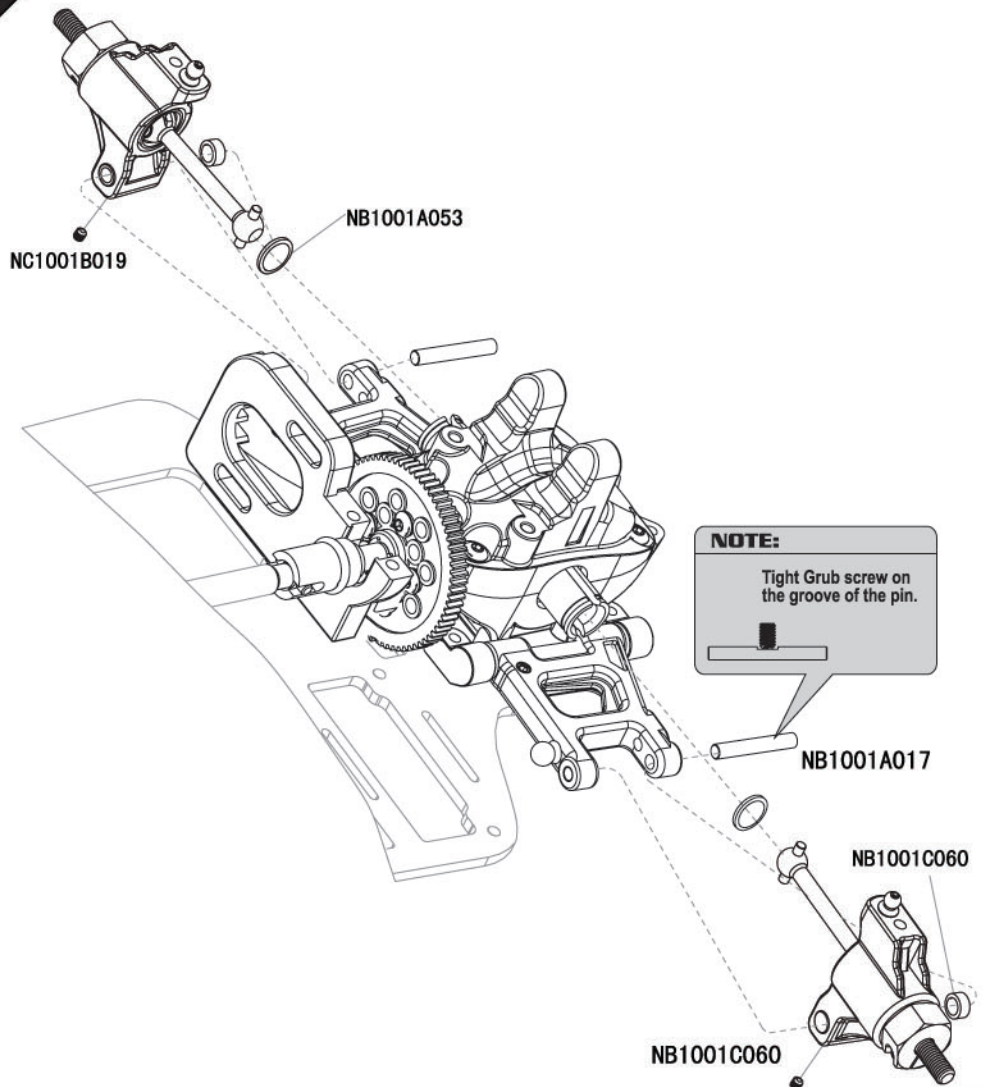

16

-  **BB1001B059**
M3X10mm X2
-  **NC1001B011**
M3X8mm X4
-  **NB1001A070**
3X8mm X4
-  **BB1001B063**
M3X6mm X2

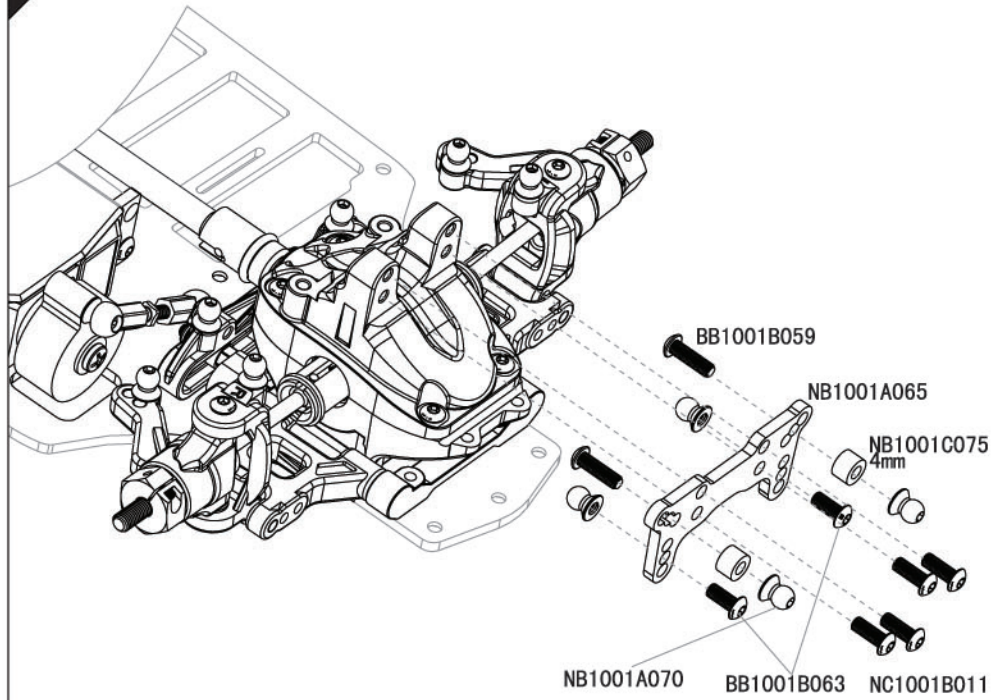

17

-  **BB1001B059**
M3X10mm X2
-  **NC1001B011**
M3X8mm X6
-  **NB1001A070**
3X8mm X4

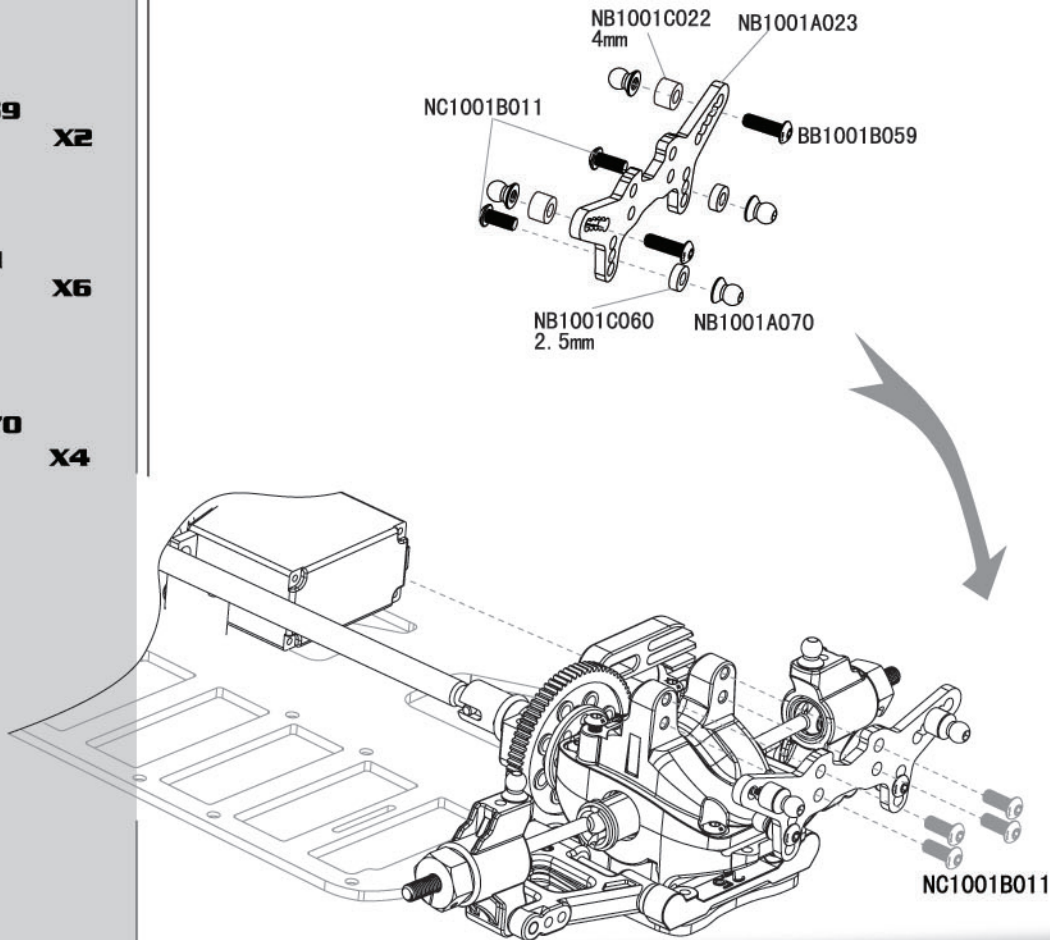

18



X14

NB1001C019



X2

NB1001A031
M3X12mm

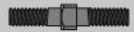

X5

NB1001A032
M3X19mm

X2

NB1001A031

NB1001C019

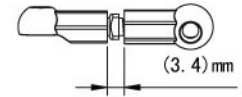

A

X2

NB1001A032

NB1001C019

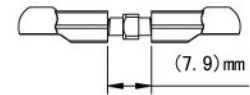

B

X1

NB1001A032

NB1001C019

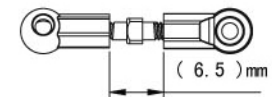

C

X2

NB1001A032

NB1001C019

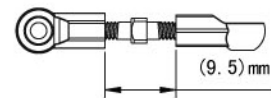

D

Note:

Direction note

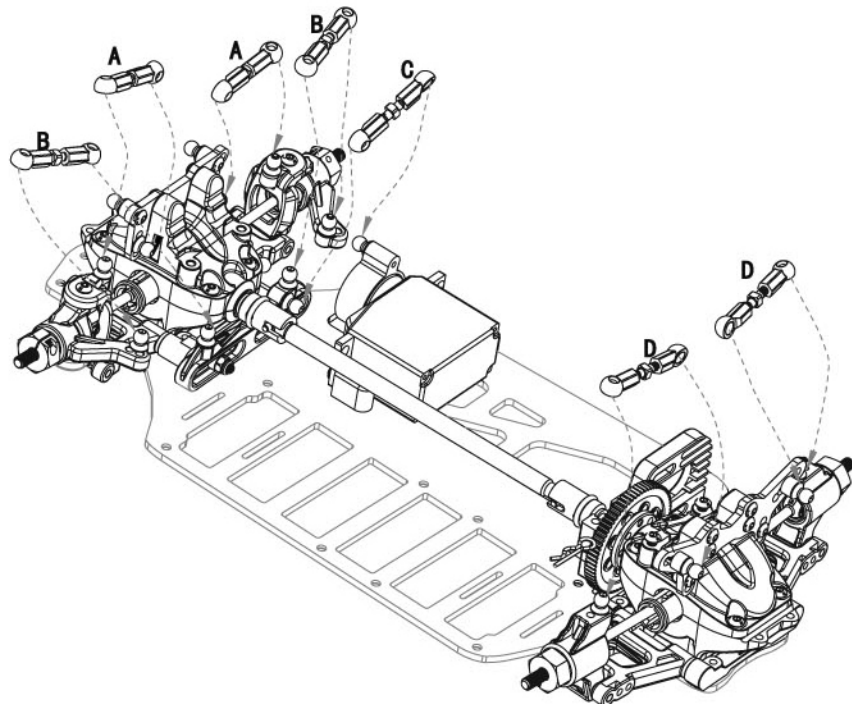

19

X4
BB1001B014
M3X8mm

X4
NC1001B003
M3X6mm

X1
BB1001B063
M3X6mm

X4
NC1001B011
M3X8mm

X2
BB1001B002
M3X18mm

X2
BB1001B059
M3X10mm

X1
NC1001B019
M3X4mm

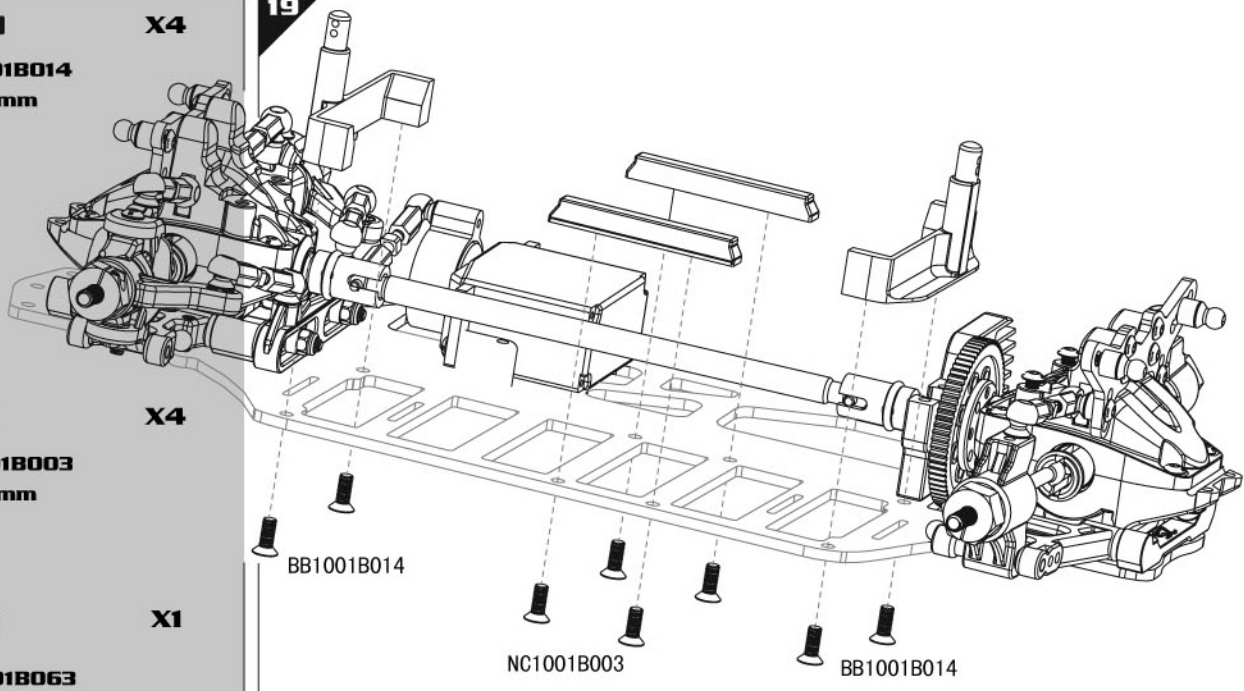

20

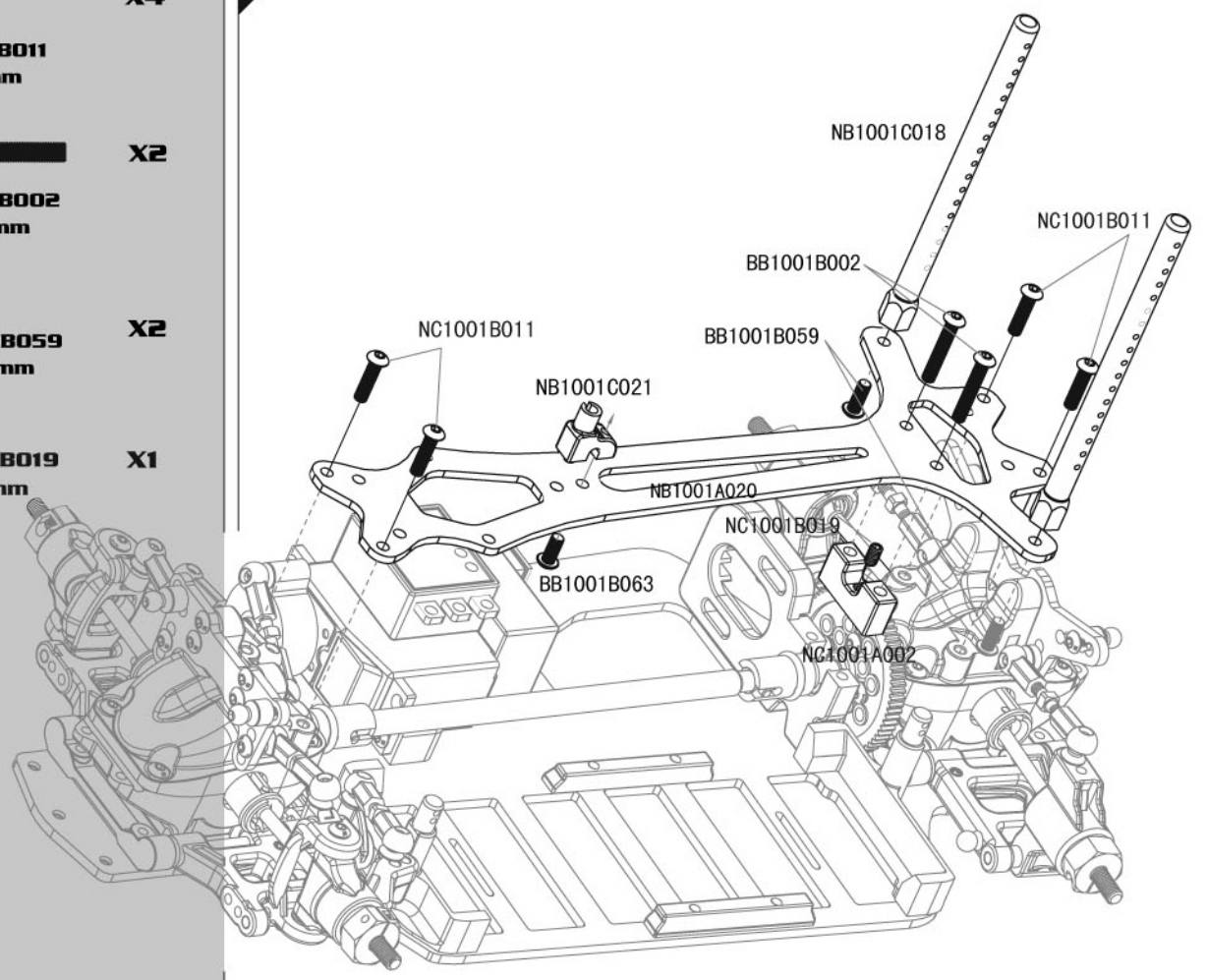

	NB1001A038	X4
	NB1001A040	X4
	NB1001B013 2X5X0.5mm	X8
	NC1001A054	X4
	NB1001D004 2.9X6.6mm	X4
	NB1001C023	X4
	NB1001C076	X4
	NB1001C026	X4
	NB1001B001	X4
	NB1001A034	X4
	NB1001A039	X4
	NB1001D003 11X13X1mm	X4
	NB1001C036	X4
	NB1001C025	X4
	NB1001D002	X4
	NB1001D009	X4

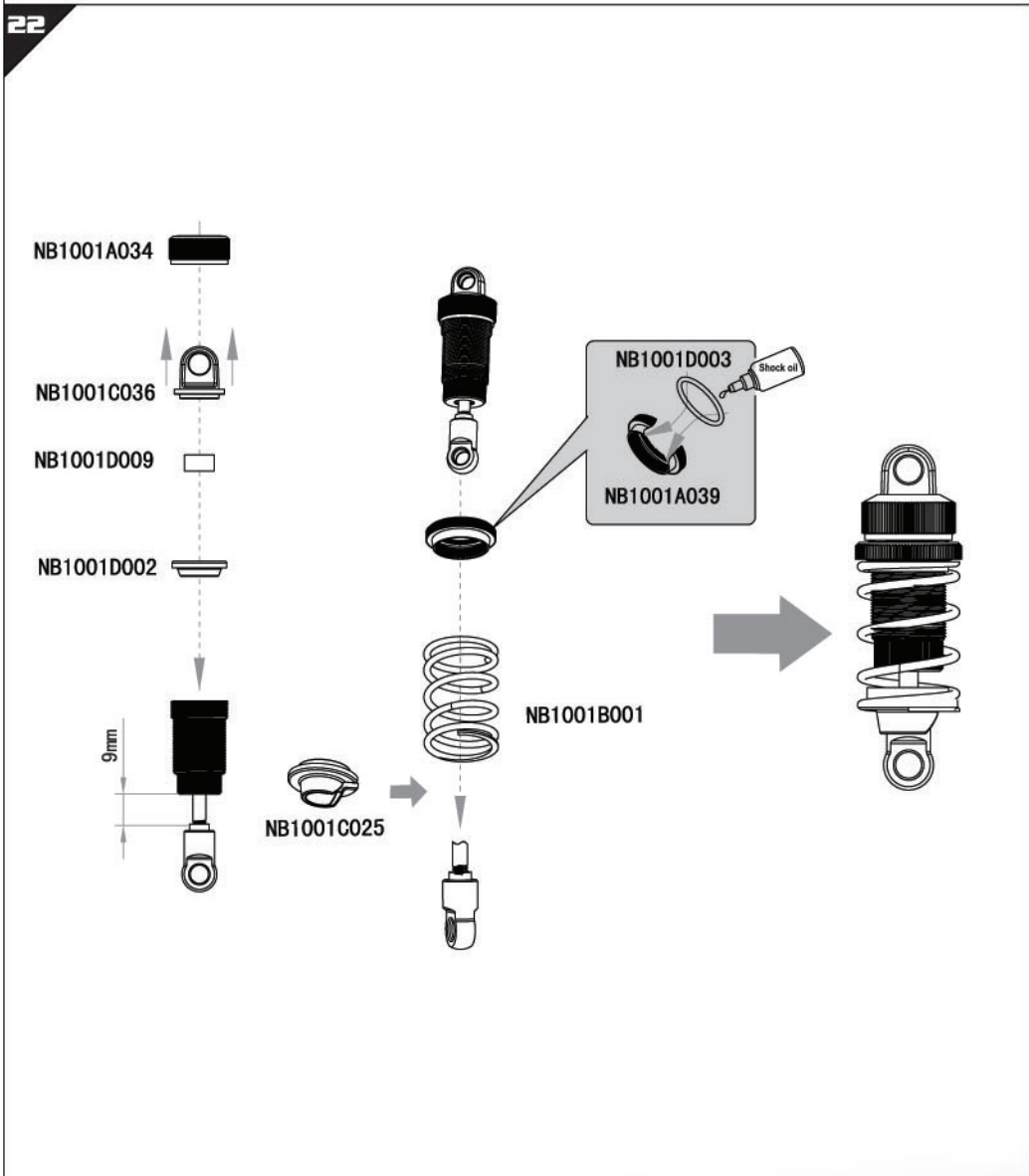
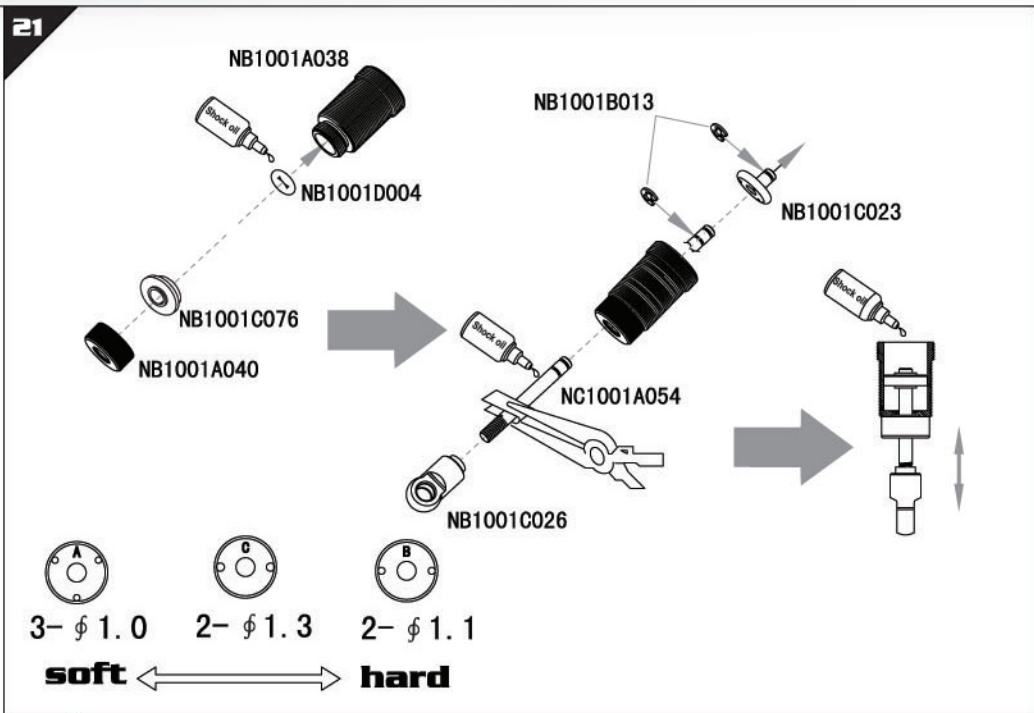

23

NA1001B015
M3X8mm

X2

NB1001A070
3X8mm

X4

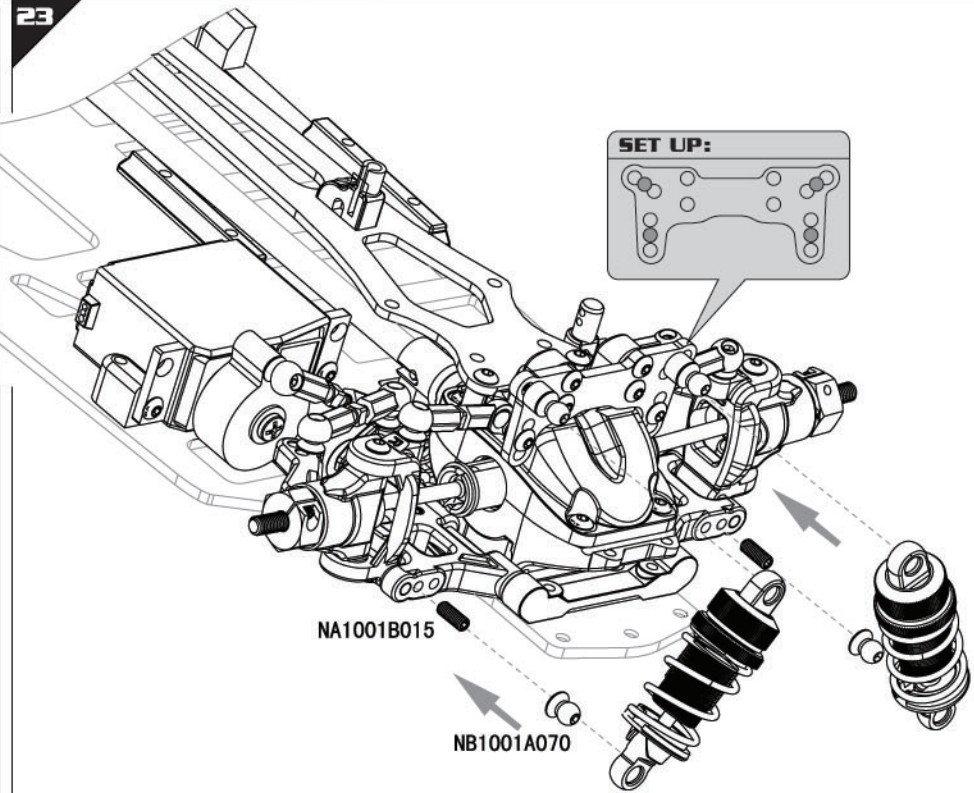

24

NA1001B015
M3X8mm

X2

NB1001A070
3X8mm

X4

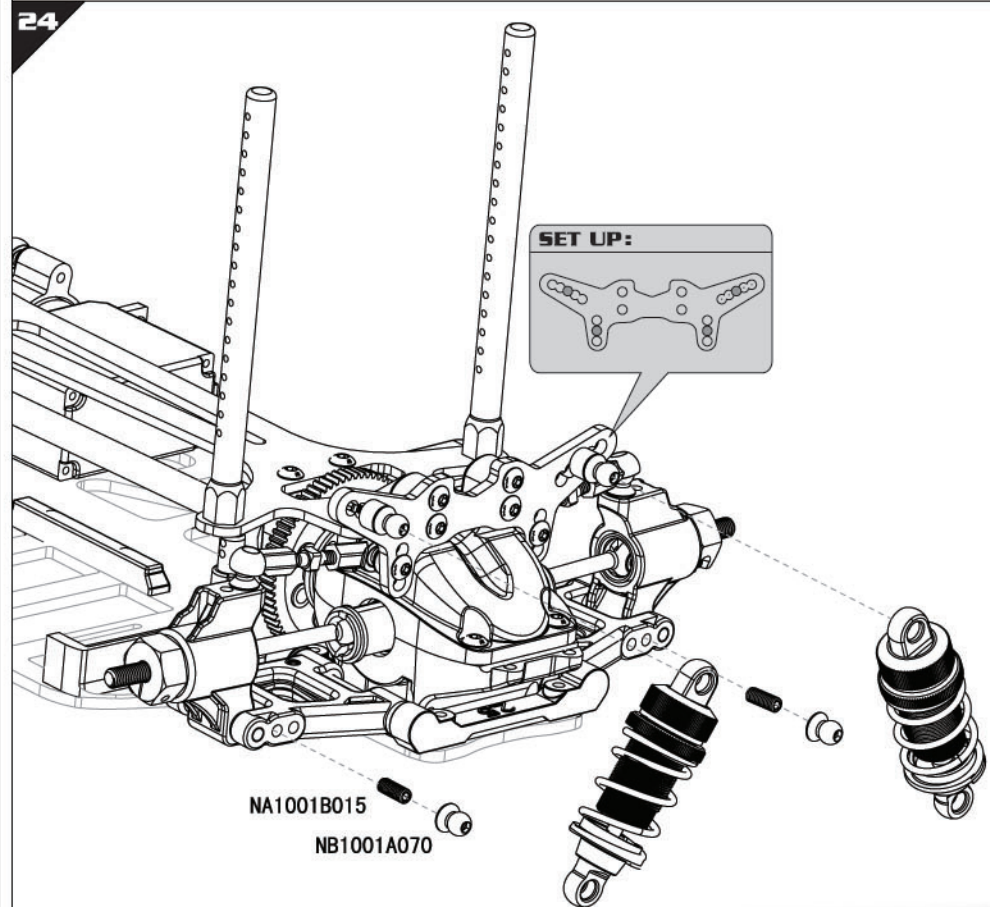

25



X5

BB1001B014
M3X8mm



X2

BA1001A061



X2

NC1001B011
M3X8mm

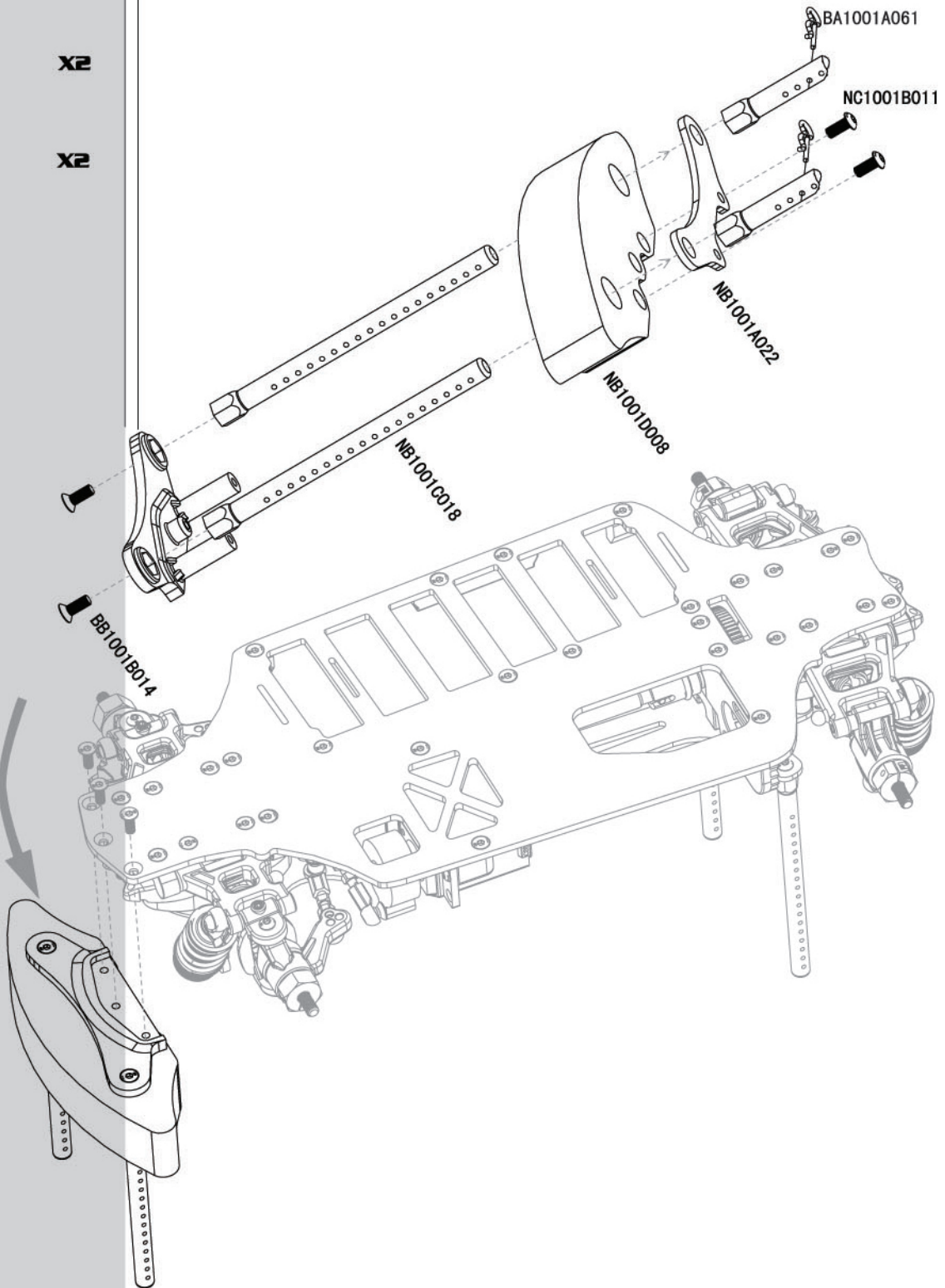

26

-  **X1**
BA1001B022
M3X3mm
-  **X2**
BA1001B046
M3X10mm
-  **X1**
NB1001A055
-  **X2**
NC1001B009
3X6.5X0.5

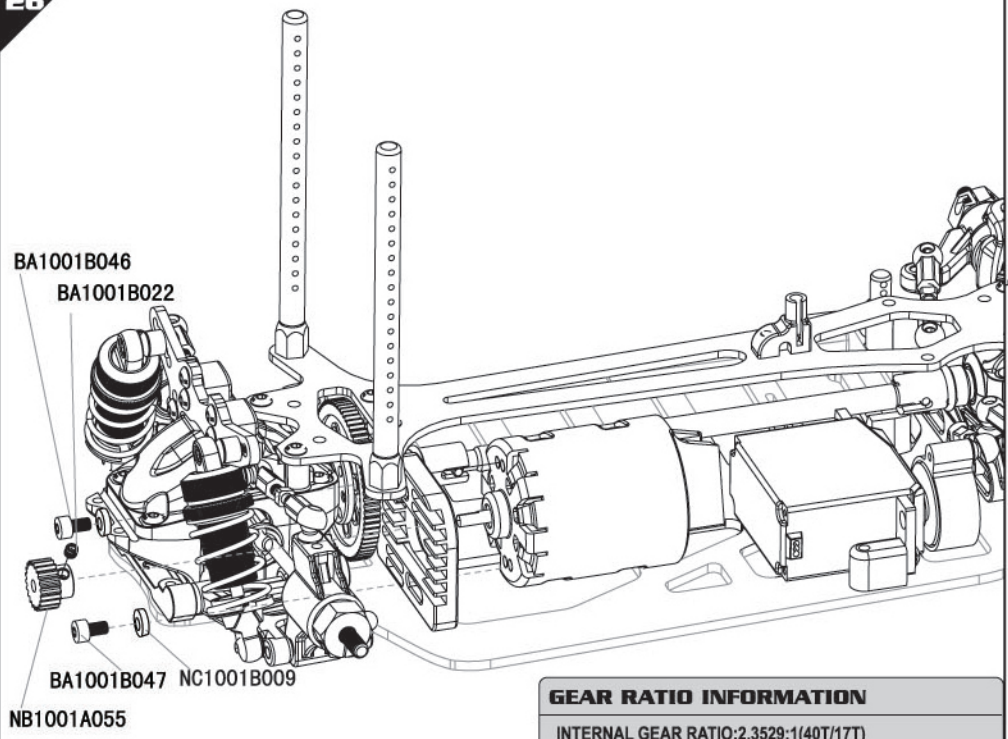

RECOMMENED GEARING

STOCK27T	5.46~5.13
STOCK23T	5.84~5.29

GEAR RATIO INFORMATION

INTERNAL GEAR RATIO:2.3529:1(40T/17T)
 SPUR GEAR:72T(48PITCH)
 PINION GEAR:31T(48PITCH)
 STANDARD GEAR RATIO:5.46
 (1/10TOURING CAR GEAR RATIO)/(1.16)=NRX-12
 GEAR RATIO

PINION GEAR	GEAR RATIO	PINION GEAR	GEAR RATIO
22T	7.70	31T	5.46
23T	7.37	32T	5.29
24T	7.06	33T	5.13
25T	6.78	34T	4.98
26T	6.52	35T	4.84
27T	6.27	36T	4.71
28T	6.05	37T	4.58
29T	5.84	38T	4.46
30T	5.65	39T	4.34
		40T	4.24

27

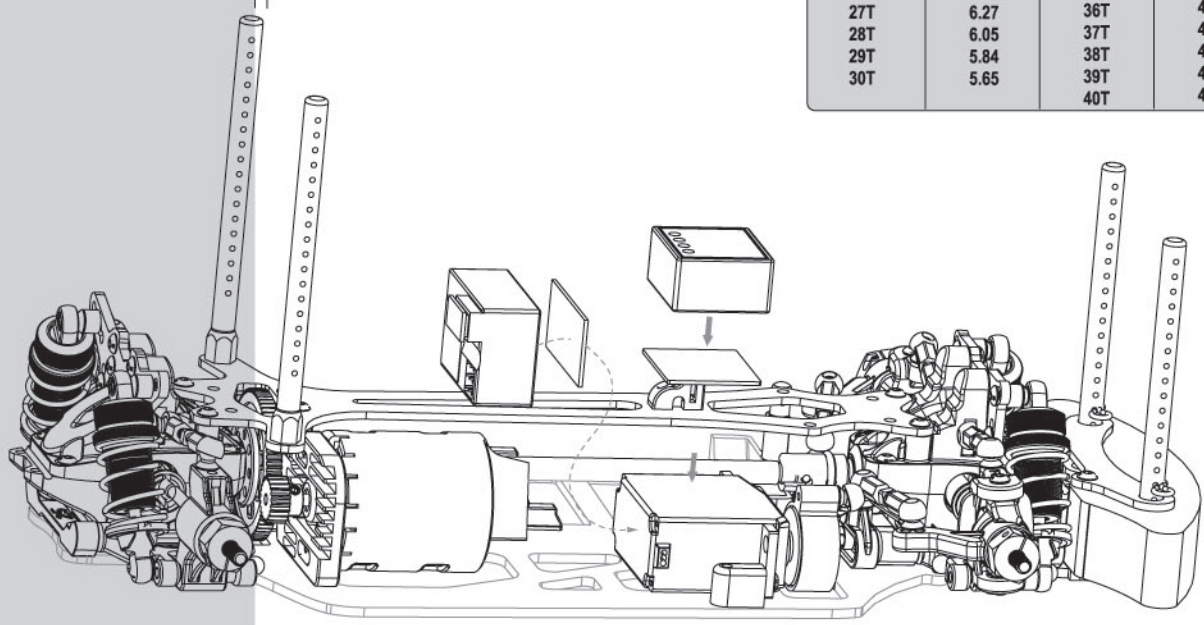

28

X4

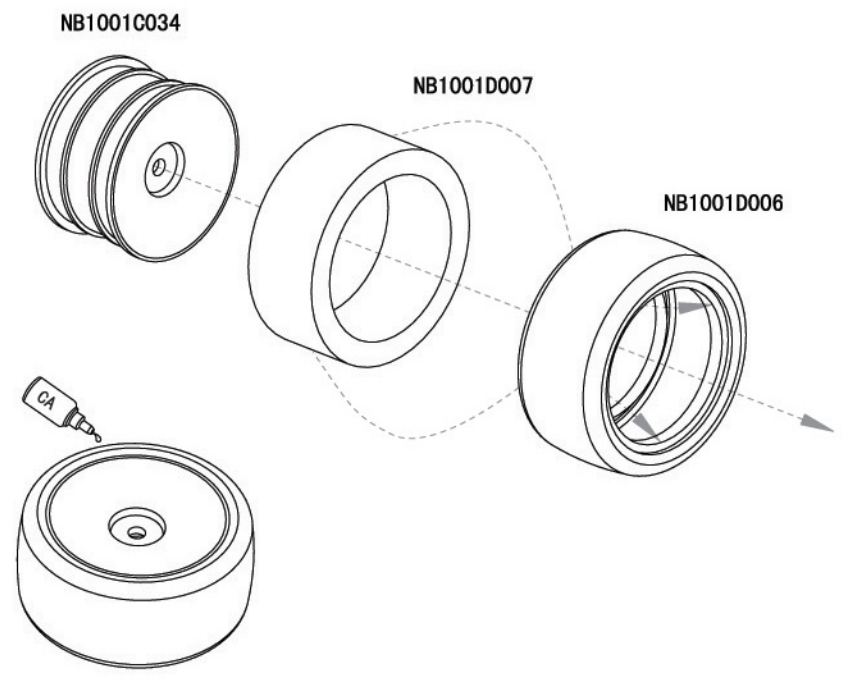

29

X4

NC1001B010
M4

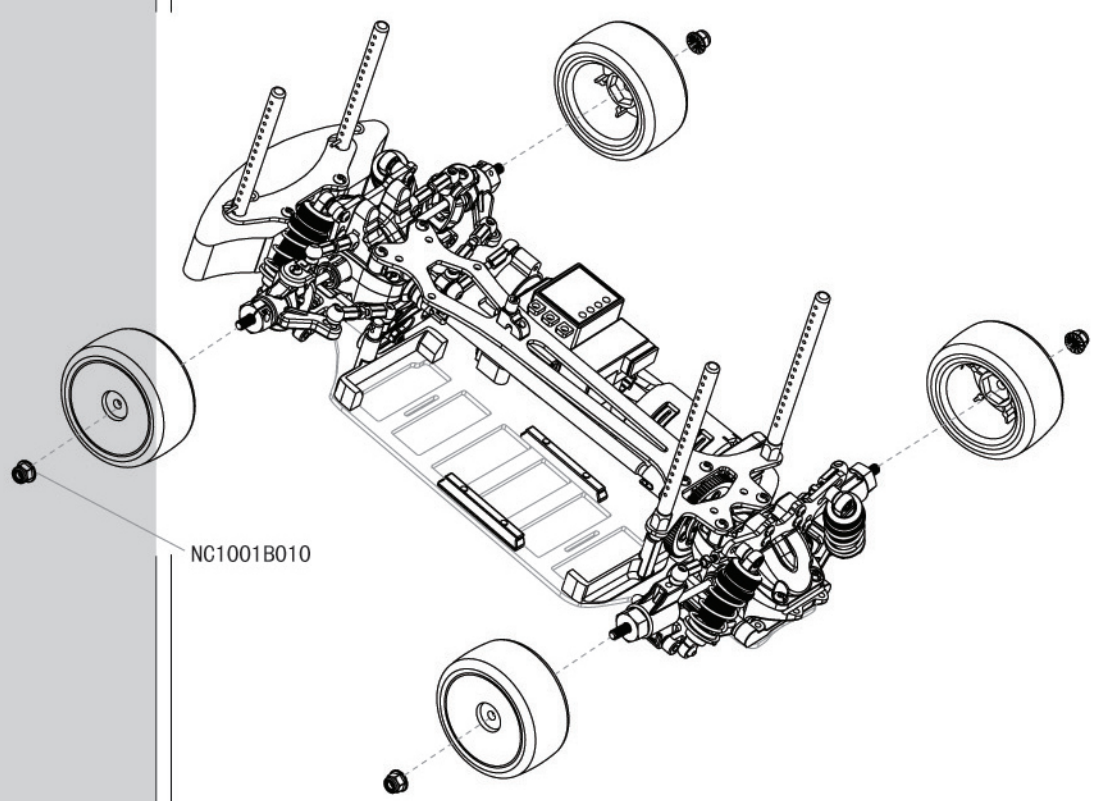

30

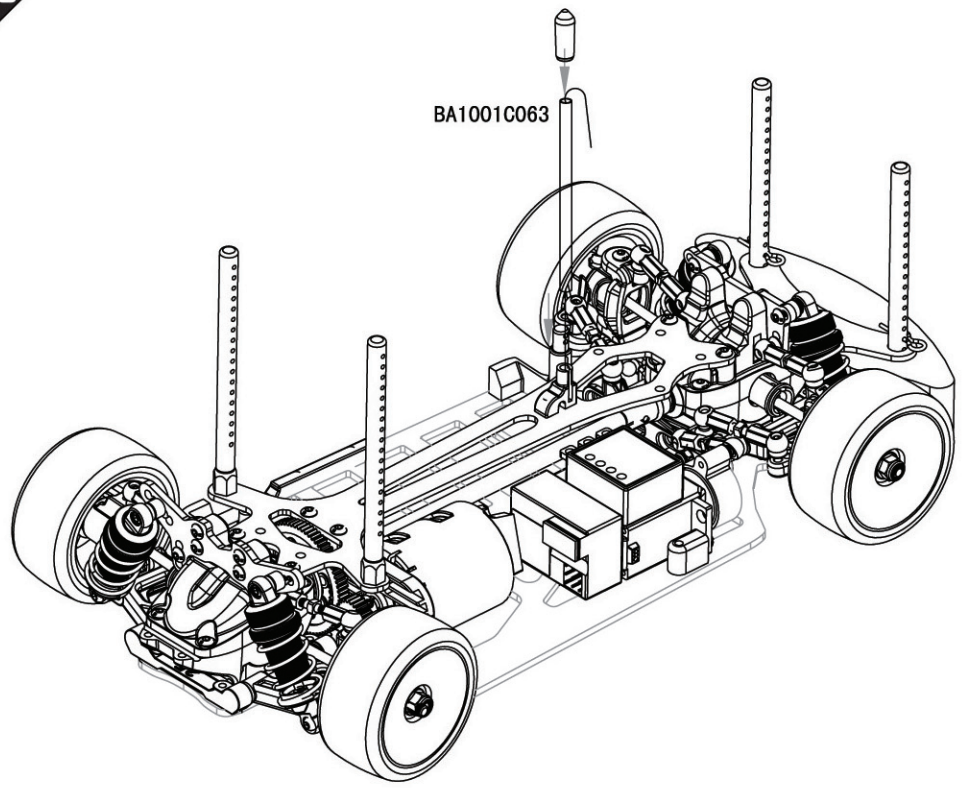

31



X2

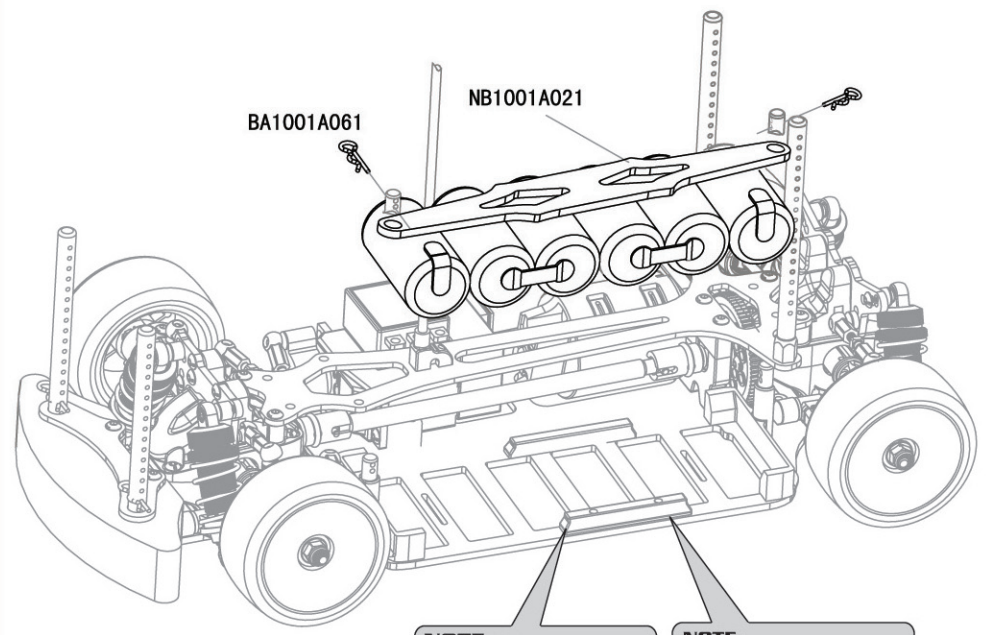

BA1001A061



NOTE:
If use LiPo battery
disuse this

NOTE:
Compatible with LiPo battery
L: 138mm
W: 46mm
H: 25mm

32

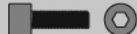
	X8
BA1001A061	
	X2
NC1001B011 M3X8mm	
	X2
BA1001B016 M3	
	X2
ML1001B007 M2X6	

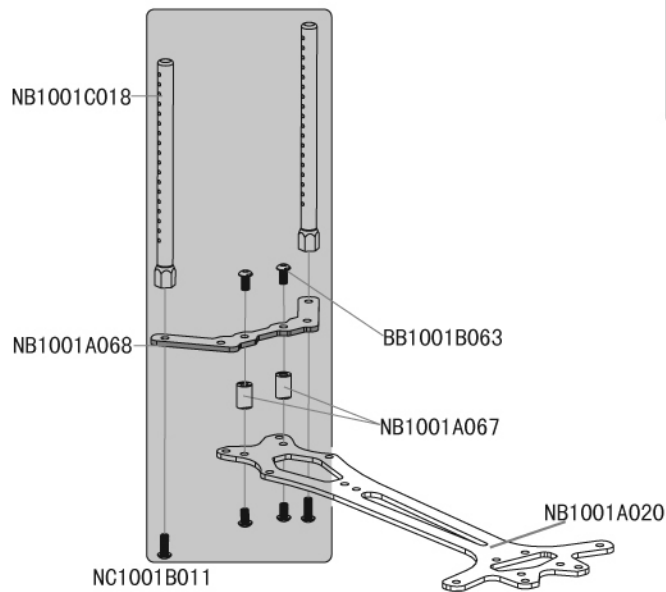
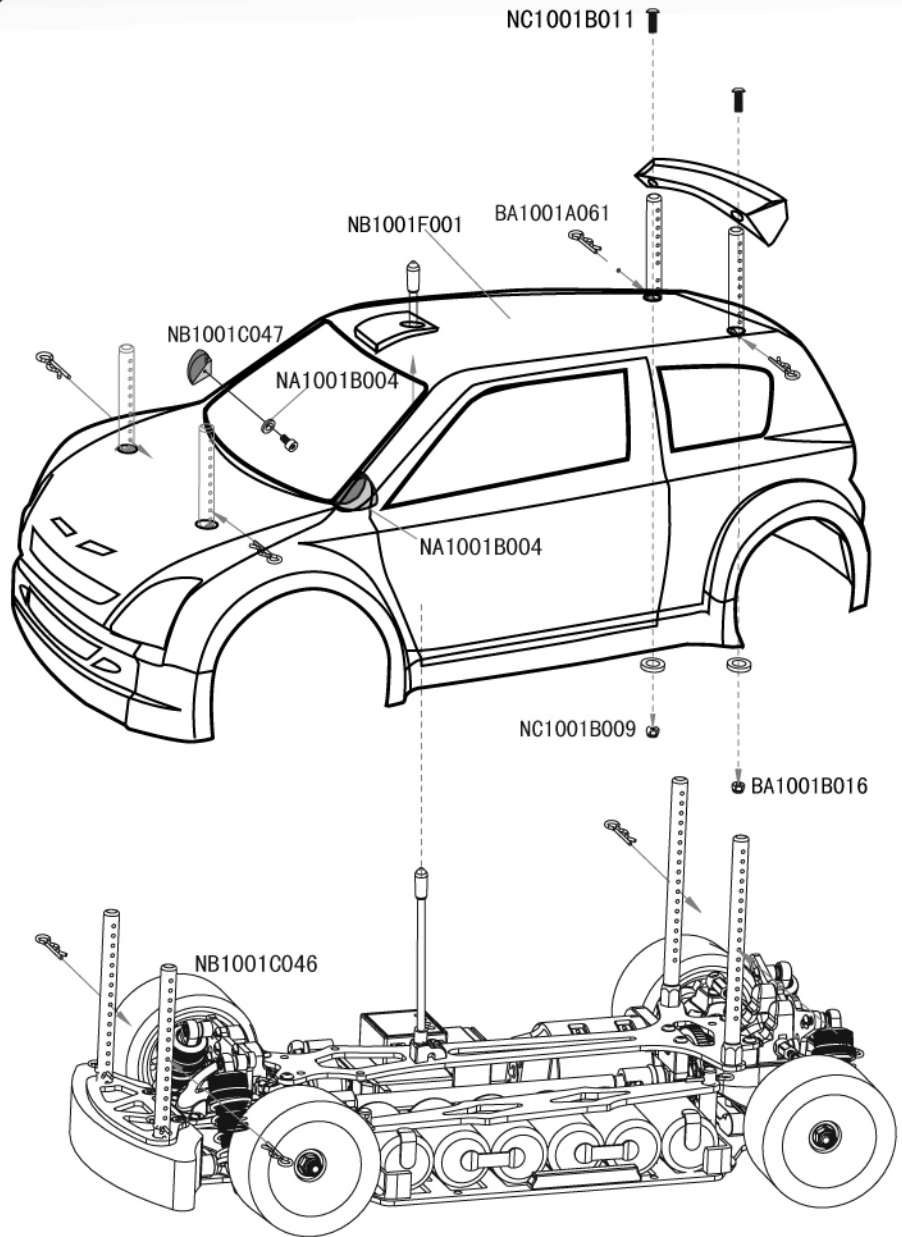

OPTION:
Part NO:NB3003
Fron body post set is used for other M chassis bodies

Please keep this OPERATING INSTRUCTION MANUAL for reference



Add: Jinchang RD, Jinxi Town, Kunshan City, Jiangsu, China.

Tel: +86(512)57220138 +86(512)57220139

Fax: +86(512)57220134

E-mail: info@nandaracing.cn

Http:// www.nandaracing.cn

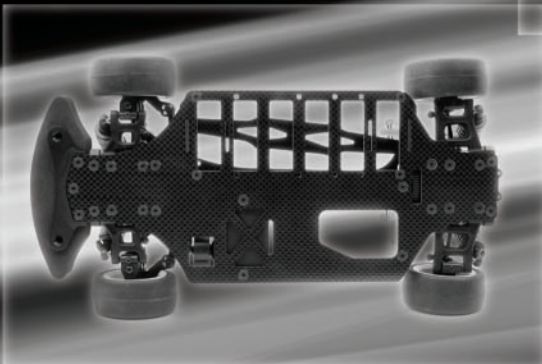
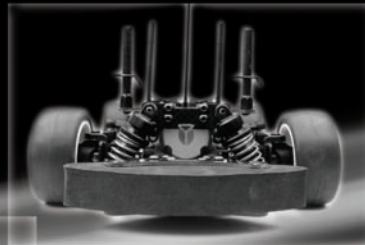

www.nandaracing.cn